



ZWBPD010010

齿轮箱规格 Gearbox specifications

外径	Outer diameter	10mm	轴承	Bearing	烧结轴承 Porous Bearing	滚动轴承 Rolling bearing
材质	Material	塑料 Plastic	轴向窜动	Axial endplay	≤0.3mm	≤0.2mm
旋转方向	Direction of rotation	cc & ccw	输出轴径向负载	Radial loading on output shaft	≤1N	≤7N
齿轮箱回程差	Gear backlash	≤3°	工作温度	Operating temperature range	-20 ~ +85°C	

齿轮级数 Gearbox stages

	1	2	3	4	
传动比	Transmission ratio	4 / 6	13 / 19 / 28	46 / 69 / 102 / 151	168 / 249 / 368 / 546 / 809
最大容许扭力 (gf.cm max)	Max rated torque of gear box	1300	1300	1300	1300
瞬间容许力矩 (gf.cm max)	Instant torque of gear box	4000	4000	4000	4000
齿轮箱效率	Gearbox efficiency	85	73	65	58
长度	Length	9.7	12.8	15.9	19

技术插图 | Technical illustrations

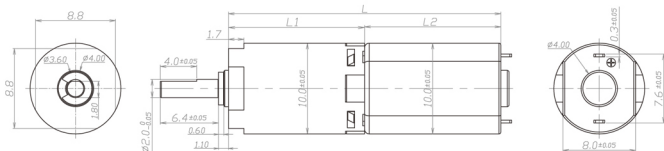

马达规格参数 Motor specifications

马达(可选择) Motors(Optional)	直流有刷电机、直流无刷电机、步进电机 DC brush motor, DC brushless motor, Stepper motor	输入速度 Input speed	≤30000rpm
电压(可选择) Voltage(Optional)	3-24V	电流 Current	150MA max

型号 Model	Rated Speed 额定转速	Max Speed 最高转速	Max Rated Torque 额定容许力矩	Max Instant Torque 瞬间容许力矩	Gear Ratio 减速比	Length 减速箱长 L1	Overall Length 总长 L
	rpm	rpm	gf.cm	gf.cm		mm	mm
ZWBPD010010-4	1875	7500	1300	4000	4	9.7	24.7
ZWBPD010010-6	1250	5000	1300	4000	6		
ZWBPD010010-13	577	2308	1300	4000	13	12.8	27.8
ZWBPD010010-19	395	1579	1300	4000	19		
ZWBPD010010-28	268	1071	1300	4000	28		
ZWBPD010010-46	163	652	1300	4000	46	15.9	30.9
ZWBPD010010-69	109	435	1300	4000	69		
ZWBPD010010-102	74	294	1300	4000	102		
ZWBPD010010-151	50	199	1300	4000	151		
ZWBPD010010-168	45	179	1300	4000	168		
ZWBPD010010-249	30	120	1300	4000	249	19	34
ZWBPD010010-368	20	82	1300	4000	368		
ZWBPD010010-546	14	55	1300	4000	546		
ZWBPD010010-809	9	37	1300	4000	809		

注：可根据客户要求定制 Can customize product as requirements